

2 3/8" CONCRETE VIBRATOR
EXPLODED DRAWING

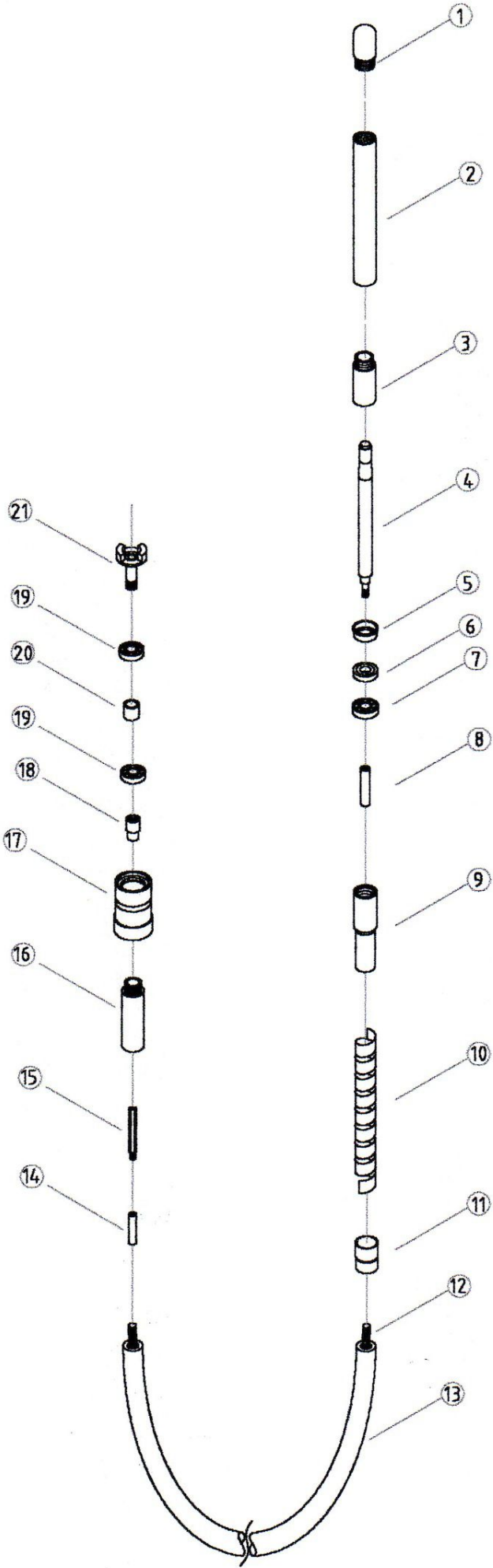

| REF.NO | DESCRIPTION | REF.NO |
|--------|----------------------|--------|
| 1 | HEAD CAP | 1 |
| 2 | VIBRATOR BODY | 1 |
| 3 | OIL SEAL HOLDER | 1 |
| 4 | VIBRATING SHAFT | 1 |
| 5 | OIL SEAL COLLAR | 1 |
| 6 | OIL SEAL | 1 |
| 7 | BEARING | 1 |
| 8 | LOW END SHANK | 1 |
| 9 | POKER END CASING | 1 |
| 10 | LINER | 1 |
| 11 | LINER GUIDE | 1 |
| 12 | FLEXIBLE SHAFT | 1 |
| 13 | HOSE | 1 |
| 14 | LOW END SHANK | 1 |
| 15 | HEXAGON END SHANK | 1 |
| 16 | CONNECTOR END CASING | 1 |
| 17 | HOSE CONNECTOR | 1 |
| 18 | HEXAGON END NUT | 1 |
| 19 | BEARING | 1 |
| 20 | COLLAR | 1 |
| 21 | SHAFT COUPLING | 1 |